

New Nozzle



Nozzle (shown with key facing downward)



Threading Tool

NOZZLE REPLACEMENT INSTRUCTIONS

FOR PURELL® HIGH-CAPACITY WALL DISPENSER ONLY

Replace the nozzle as needed.

If retrofitting an existing dispenser, remove black funnel by pressing down.

INSTRUCTIONS:

- 1.** Tilt the nozzle into opening.



- 2.** Hold one side of nozzle and use force to push other side until it snaps into place.

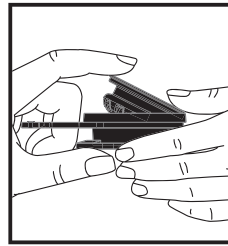

- 3.** Unlock and open dispenser.



- 4.** Slide nozzle with key toward back of dispenser.

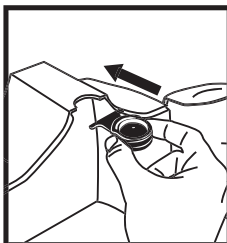

- 5.** Hold nozzle in place. Use Wipe Threading Tool to push wipe through opening in flexible rubber piece.

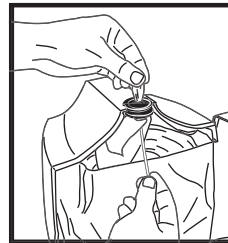

- 6.** Close and lock dispenser.

