

# PRODUCT PLACEMENT GUIDE FOR MANUFACTURING FACILITIES

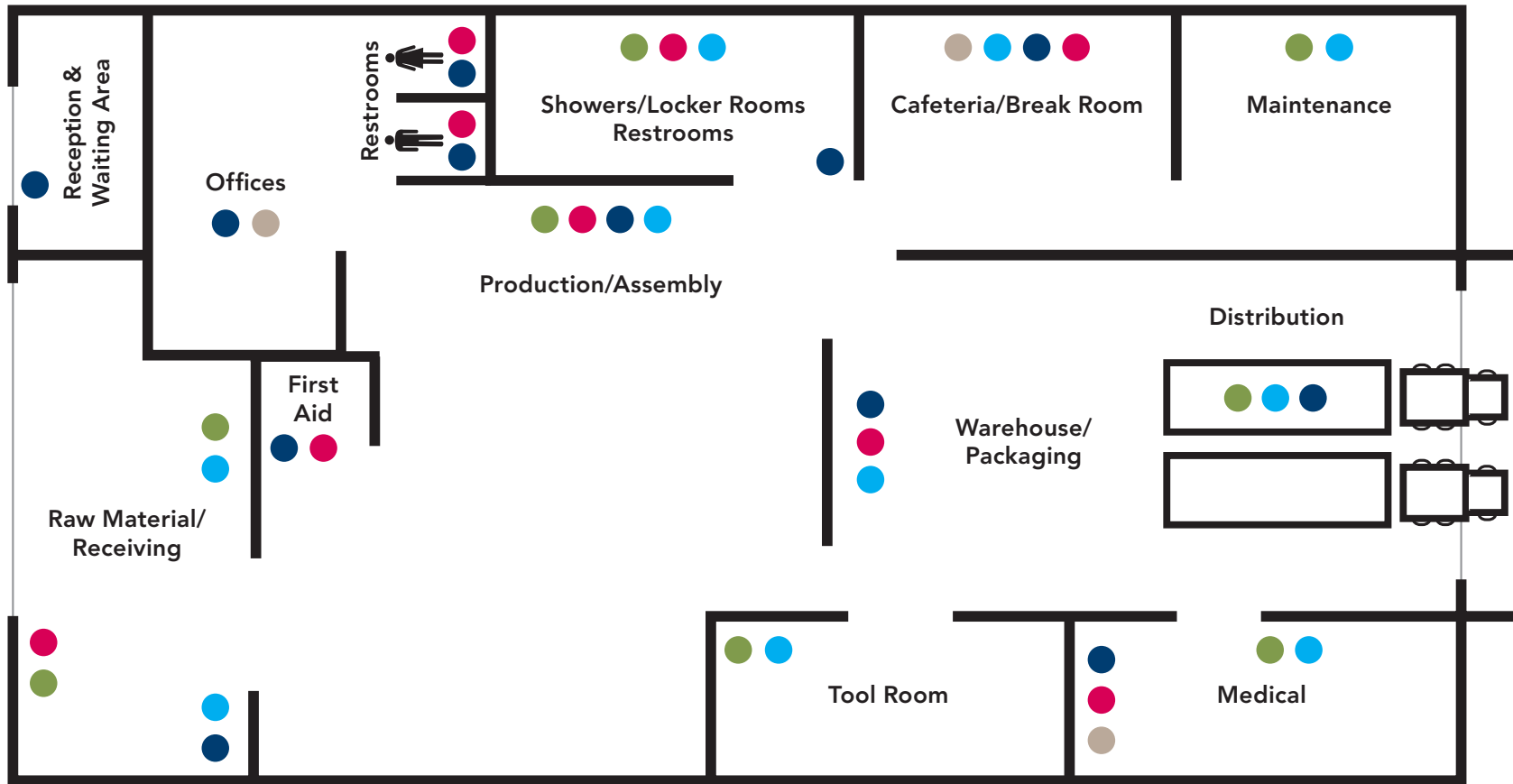

● HEAVY DUTY CLEANSING FOR HANDS & SURFACES

● CONDITIONING FOR HANDS

● GENERAL CLEANSING FOR HANDS & SHOWER

● SANITIZING FOR HANDS

● DISINFECTING FOR SURFACES





## SANITIZING



### PURELL® Professional Advanced Hand Sanitizer Foam

PURELL ES4 1200 mL Refill	5054-02
PURELL ES6 1200 mL Refill	6454-02
PURELL ES8 1200 mL Refill	7754-02



### PURELL Hand Sanitizing Wipes

270 count Canister	9113-06
100 count Canister	9111-12



### PURELL Professional Surface Disinfectant

4 – 1 Gallon Refills	4342-04
6 – 32 fl. oz Bottles capped & sealed w triggers	3342-06



## GENERAL CLEANSING



### PURELL Professional CRT HEALTHY SOAP® Naturally Clean Fragrance Free Foam

PURELL ES4 1200 mL	5070-02
PURELL ES6 1200 mL	6470-02
PURELL ES8 1200 mL	7770-02



### PURELL Professional HEALTHY SOAP® Mild Foam

PURELL ES4 1200 mL	5074-02
PURELL ES6 1200 mL	6474-02
PURELL ES8 1200 mL	7774-02



### PURELL Professional HEALTHY SOAP 0.5% BAK Antimicrobial Foam

PURELL ES4 1200 mL	5079-02
PURELL ES6 1200 mL	6479-02
PURELL ES8 1200 mL	7779-02
PURELL FMX-20™ 2000 mL	5279-02



### GOJO Citrus Ginger Foam Hand & Showerwash

ADX-12 Manual 1250 mL Refill	8813-03
------------------------------	---------



## HEAVY DUTY CLEANSING



### GOJO® MULTI GREEN® Hand Cleaner

PRO™ TDX™ 5000 mL Refill	7565-02
PRO TDX 2000 mL Refill	7265-04

### GOJO MULTI GREEN ECO Hand Cleaner

1 Gallon Bottle	2359-04
1/2 Gallon Bottle	0989-04
10 oz Bottle	2357-08



### GOJO SUPRO MAX™ Hand Cleaner

PRO TDX 5000 mL Refill	7572-02
PRO TDX 2000 mL Refill	7272-04
1 Gallon Bottle	0979-02
1/2 Gallon Bottle	0972-04
10 oz Bottle	7278-08

### GOJO SUPRO MAX Cherry Hand Cleaner

PRO TDX 5000 mL Refill	7582-02
PRO TDX 2000 mL Refill	7282-04



### GOJO Scrubbing Towels

170 count Bucket	6398-02
72 count Bucket	6396-06



## CONDITIONING



### GOJO HAND MEDIC® Professional Skin Conditioner

ADX-7™ Manual 685 mL Refill	8745-04
5 oz Tube	8150-12