

# GOJO LTX-12™ Behavioral Health Dispensing System

These instructions apply to GOJO®, PURELL®, PROVON® brand LTX-12 dispensers.

*Please carefully read all instructions before using the dispenser.*

## Change Refill

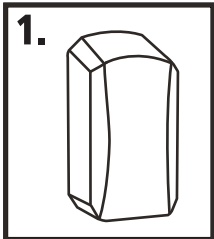

1. Insert supplied barrel key into the lock on the right side of the dispenser. The lock will capture the key until while in the unlocked position. Once unlocked, open the dispenser cover.

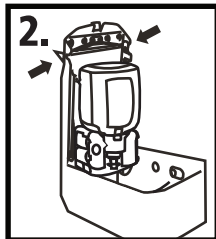

2. **WARNING:** use caution to avoid touching the internal ligature slicers when opening the dispenser. They are extremely sharp.

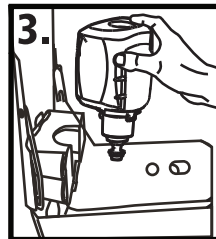

3. Remove empty refill from the dispenser. Insert a fresh refill in its place.

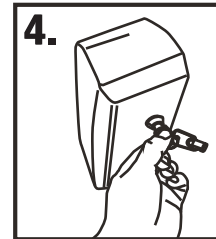

4. Close the dispenser cover and turn the key to the locked position. Remove the key.

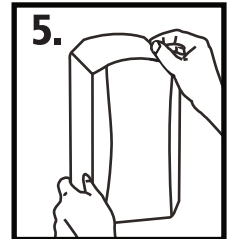

5. Carefully verify that the dispenser is completely closed, locked and will not open. There should be minimal to no movement of the cover in any direction.

## Change Batteries

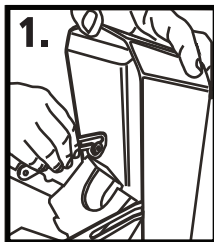

1. The pump house must be removed to change the batteries.

Follow steps 1 & 2 above to unlock and open the dispenser.

Once open, remove the refill. Disconnect the guide arms from guide nubs by sliding arm down to the nub, then lifting arm away from the guide nub.

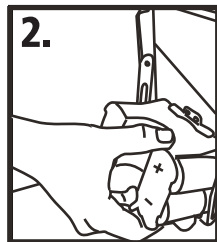

2. Grip pump house and push up against the spring tab. Angle pump house out from the lower slots. Remove pump house from dispenser.

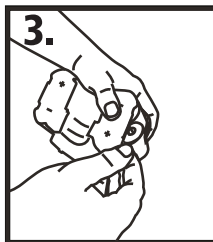

3. Remove old batteries. Replace with four (4) fresh alkaline D-cell batteries, being careful to align the batteries based on the +/- markings on the pump house.

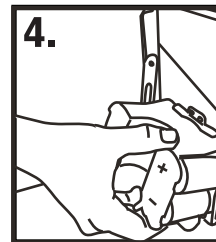

4. Place pump house back in cabinet top-first, with the bottom angled out. Push up against the spring tab then slide the bottom of the pump house into the lower tab slots. Make sure the pump house is firmly in place. Place the refill back in the dispenser.

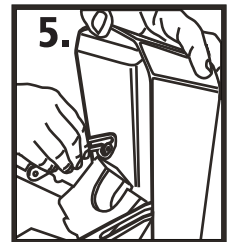

5. Re-attach the guide arms to the cover guide pins. Close and lock the cover as described in steps 4 & 5 above, being sure to check that the cover is securely closed. Place hand under dispenser to verify it is working properly.

## Sustainability & Recycling

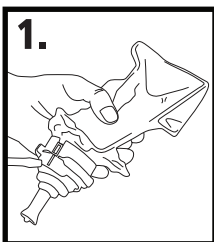

1. Remove collar and cap on the refill bottle and discard.



2. Bottle is recyclable.



GOJO Industries, Inc.  
One GOJO Plaza, Suite 500  
P.O. Box 991 • Akron, OH 44309-0991  
Tel: 1-330-255-6000 • Toll-free: 1-800-321-9647  
Fax: 1-800-FAX-GOJO

©2016. GOJO Industries, Inc. All rights reserved. #17480